

IN-WALL BOX FAN

PRODUCT PROFILE (SEE OVER FOR TECHNICAL DETAILS)



IN WALL BOX FAN (IWBF-12v)

DESCRIPTION:

The IWBF-12V is suitable for moving small to medium air volumes against low static resistance. (Short distances no longer than 7m)

BENEFITS:

- Extracts 3,960 litres per minute (At free air. Refer to Fan performance graph for performance under pressure)
- Designed and manufactured in Australia
- Low wattage (Consumes 9 Watts)
- Half Chevron Louvre comes with stainless steel (5mm mesh)
- Can be used with rigid or flexible ducting
- Quiet Operation
- Easy to install (2 brick by 1 brick cut-out)
- DC Brushless Fan Motor for maintenance free operation and continuous running
- Standard Finish: Anodized Aluminium. (Powder coat finish available in complete range of colours on request)
- Comes with 12Volt transformer with 1.8m lead
- Supply air option available (reverse configuration)

WARRANTY:

- 1 Year (Extended warranty may apply)

APPLICATIONS:

Suitable for both supply and exhaust requirements. The IWBF is ideal for sub-floor ventilation (to mitigate rising damp), bathroom ventilation and for fresh air supply.

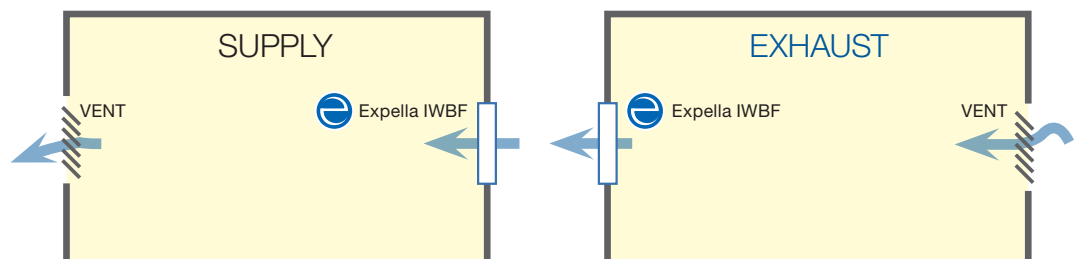

IN-WALL BOX FAN

TECHNICAL DETAILS (SEE BACK FOR PRODUCT PROFILE)

SPECIFICATIONS:

Model	Item Code	m3/h	L/s	Pa	W	dB(A)*	RPM
IWBF-12	1EX5000	238	66	90	9.0	42	2200

*Measured at 1m

DIMENSIONS:

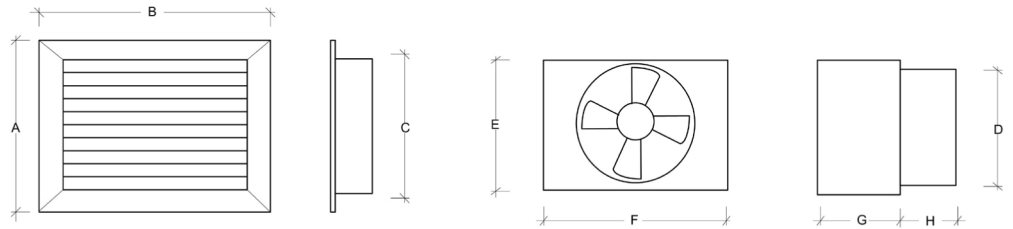

A	B	C	ØD	E	F	G	H
200	255	156	150	165	230	100	70

PERFORMANCE:

